



**This manual has been prepared for the owners and operators of the Armedica by Pivotal Health Solutions AMTM series MAT Tables. It contains installation instructions, instructions for use, precautionary information, and maintenance procedures for the following model numbers:**

**AMTM-640, 650, and 660 ELECTRIC HI-LO MAT TABLES**



**ISO 13485**  
FM 50089  
Made in the U.S.A

Dear Customer,

ARMEDICA by: Pivotal Health Solutions is a proud manufacturer of the world's leading physical therapy devices, and we appreciate you for choosing us! Every device that leaves this facility is manufactured and assembled by hand, using the latest next generation technology, by the men and women of our community located in the Central U.S.A. Our goal is to design, develop, and produce the highest quality product, in hopes to improve the quality of care to every patient, and achieve complete customer satisfaction.

Thank you, for choosing us.

This User's Manual is for the following AMTM Series MAT Tables only

**AMTM-640** – 4x7 ELECTRIC HI-LO MAT TABLE.  
**AMTM-640 Total mass weight 290Lbs./131Kgs**

**AMTM-650** – 5x7 ELECTRIC HI-LO MAT TABLE.  
**AMTM-650 Total mass weight 327Lbs./148Kgs**

**AMTM-660** – 6x8 ELECTRIC HI-LO MAT TABLE.  
**AMTM-660 Total mass weight 415Lbs./188Kgs**



**WARNING:** Read and understand this user's manual before installing or using this equipment.  
Failure to follow operating and maintenance instructions could result in equipment damage or personal injury.



**IMPORTANT:** Do not use this manual to reference instructions, requirements, or specifications for any product other than those listed in this manual.  
Equipment damage, void of warranty and personal injury may occur.

## Table of Contents

Models covered in manual and table of contents	1
Symbols and Indicators	2
Definitions	3
Assembly and Installation	5
Operating instructions	6
Maintenance	8
Cleaning	8
Troubleshooting	9
Technical Specifications	10
Parts List & Drawings	11
Warranty information	14

## **SYMBOLS and INDICATORS**



**WARNING:** Indicates failure to follow manufacturer's operating instructions could place the patient, and/or operator at risk of harm.  
Read and understand the operating instructions listed in this manual before installing or using this equipment.



**CAUTION:** Indicates a general warning.



**WARNING:** Follow safe lifting procedures and precautions.



**WARNING:** Identifies warning of electrical shock hazard.



Instructs to follow operating instructions.



Identifies dangerous electrical information.



Type B Applied part: An Applied Part complying with the specified requirements to provide protection against electric shock, particularly regarding allowable patient leakage current and patient auxiliary current.



This device is equipped with a protective earth ground. This device may only be connected to a power source with a protectively earthed ground.



Alternating Current



Direct Current

## **SYMBOLS and INDICATORS (continued)**



Do not climb or allow children to climb on this device.



Do not stand or allow children to stand on this device.



Do not reach or allow children to reach into this device.

## **DEFINITIONS**

The AMTM Series MAT Tables are Class II devices regarding protection against electric shock.

Class II: term referring to electrical equipment in which protection against electric shock does not rely on BASIC INSULATION only, but in which additional safety precautions such as DOUBLE INSULATION or REINFORCED INSULATION are provided, there being no provision for protective earthing or reliance upon installation conditions.

Intended use: The AMTM Series powered MAT tables are intended for medical rehabilitation purposes as a patient positioning aid for various treatments or other therapies as deemed necessary by a professionally trained and licensed medical professional. This device is intended to be used in a professional medical facility where professionally trained medical personnel are continually present during use.



**CAUTION:** Using this device in a manner inconsistent with its labeling will void warranty and, damage to device or personal injury may occur.

Oxygen Rich Environment: environment in which the concentration of oxygen is:

a) greater than 25 % for ambient pressures up to 110 kPa; or b) the partial pressure of oxygen is greater than 27,5 kPa at ambient pressures exceeding 110 kPa.



**CAUTION:** This device is not suitable for use in an oxygen rich environment, in the presence of flammable anesthetics, or other flammable agents. Fire or explosion may occur.

Patient: Any person currently using this device as a positioning platform under the direction and supervision of a qualified medical professional.

## **DEFINITIONS (continued)**

**Operator:** Any medical professional, who has been trained, qualified, and authorized by the consumer or responsible organization to operate this device.



**CAUTION:** A patient is not intended to operate this device in any way. The AMTM Series MAT Tables shall be operated by trained, qualified and authorized personnel ONLY.

**Service Technician:** Any person/persons authorized by Armedica Manufacturing to perform service, component replacement or repair to the AMTM Series MAT Tables.



**CAUTION:** Service to controls and actuators must be done by the manufacturer only. In the event of an actuator, or control unit, failure, they must be returned to Armedica Manufacturing Corp. All service or repair must be performed by Armedica Mfg. authorized field service personnel only. For information, contact Armedica customer service.

**Duty Cycle:** The ratio of time the device can be in a state of continuous actuation (moving) and rest. Noted in units of minutes as ON/OFF. The Duty Cycle of this device is rated for 10%. 1(one) minute on / 9(nine) minutes off.

**Electrical power source:** This device is intended to be connected to an external electrical power source.



**WARNING:** To avoid risk of electrical shock, this device must only be connected to a supply mains with protective earth ground.

**Applied part:** An applied part is one specifically intended to come into direct contact with patient during normal use. Applied parts are identified, either in this manual or directly on the part, with this symbol . (Refer to the bill of materials on Pg. -- for list of parts and descriptions)

**Accessible Part:** An Accessible Part is any part that the patient or operator may come into direct contact with, either intentional or unintentionally, but direct contact is not required for normal operation.

**Operator Interface:** The point in which the operator will input data via momentary push button for actuation, memory function and device control.

## **ASSEMBLY & SETUP**

ARMEDICA™ MAT Platform Tables are medical electrical devices intended to be used as a patient positioning aid during exercise and/or other therapies. This device is to be used in professional medical facilities and under the supervision of professional medical personnel.

1. Remove the mat platform from the carton, leaving the foam covering on the upholstered top.
2. Place the platform top with the bottom side up on a clean, smooth surface and remove the wood packing frame and strapping from the motor on electric models. On adjustable models with a manual crank, remove strapping and install the unit referring to the picture of model AM-642.
3. Remove the screws (A) holding the legs to the underside of the table and carefully un-wrap.



**CAUTION:** Do not fold, pinch, or kink the hydraulic lines during assembly. Damage to lines may occur.

4. Gently rotate legs into position as shown and insert bolts (3) with the bolt head and finishing cap washers (27) on the outside of the table frame. Tighten bolts securely using the nuts (13) provided. Attach the black finishing caps (28) to bolt heads by pressing firmly. Extra cable clamps and screws are included for additional cable clamping if necessary.
5. Install leveling glides (33) by screwing them into the legs.
6. Place the mat platform upright and remove the foam covering. Adjust the leveling glides as needed. The mat platform is ready for use.
7. Thoroughly inspect the device for any defects, and all components and hardware is present and secured.

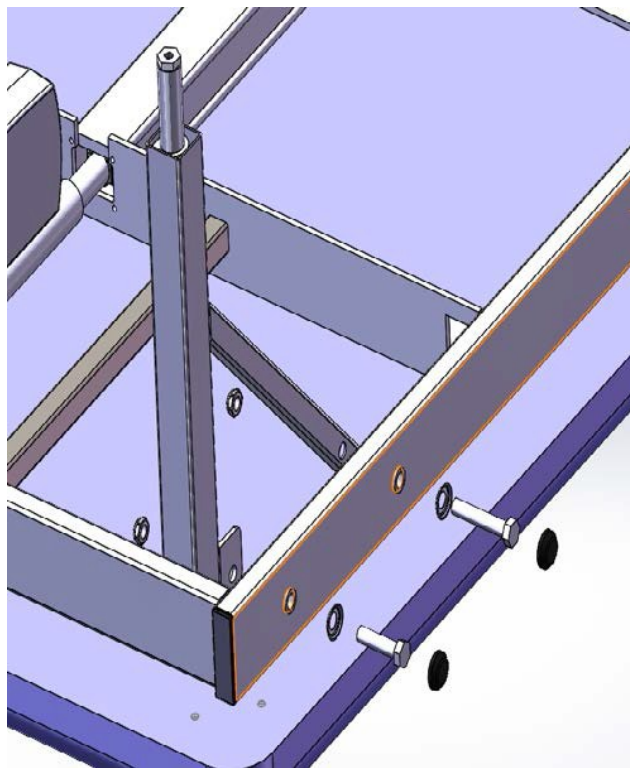
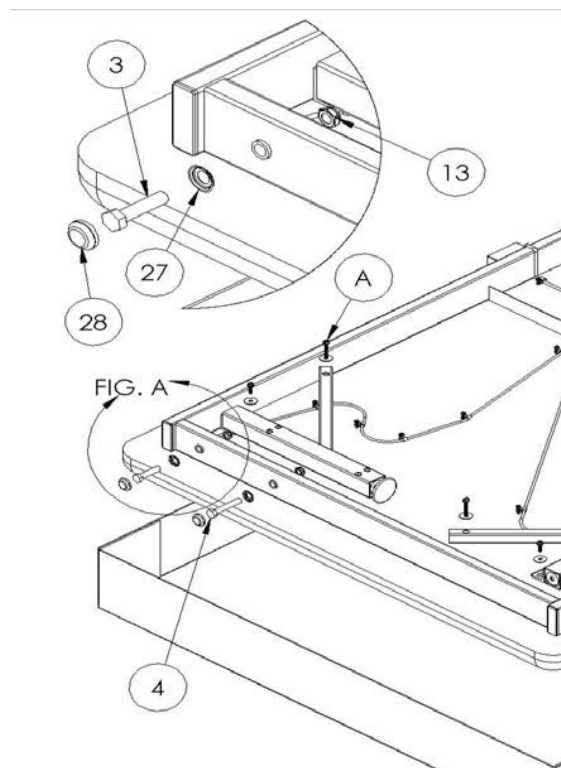

## **OPERATION**



**CAUTION:** Before using this device, ensure the area around and under the device is free and clear of any foreign objects or obstructions. Damage to device and personal injury may occur.



**WARNING:** This device may only be connected to a power source appropriate to the indicated power requirements of this device. Failure to do so may result in electric shock, fire, or death.



**CAUTION:** Before using this device, read and understand ALL instructions for use. Failure to do so may result in void of warranty, damage to the device, or personal injury.

### **Raising/Lowering**

The Armedica™ Power Mat Platform is optionally equipped with a foot/hand switch or table mounted switch. Continuous activation of switch is required for operation.

To adjust the height of the device press and hold the button for the desired direction, release button when desired position is achieved.

When lowering the device, press & hold the down arrow. A short delay in actuation will occur. The delay is accompanied by audible alarm to alert the operator that the device is going to lower.



**CAUTION:** The audible alarm and delay of downward movement is a safety feature designed to alert the operator of downward movement, and a reminder to ensure there is no personnel or objects in the path of travel. Failure to keep device free from obstructing may cause damage to the device, property, and severe personal injury.

### Operator Position

- Ensure patient is fully on the table with all appendages, accessories, and loose objects are on the upholstered top and not past edges.
- Ensure the area around and under the table is clear of any foreign objects & free from obstruction.
- The patient should be relaxed and at rest during operation.
- Adjust table to desired position.



NOTES: \_\_\_\_\_

\_\_\_\_\_

\_\_\_\_\_

\_\_\_\_\_

\_\_\_\_\_

\_\_\_\_\_



## **MAINTENANCE**



**CAUTION:** Failure to follow recommended maintenance instructions may cause damage to equipment, personal injury and void warranty.

ARMEDICA™ Manufacturing thoroughly inspects and tests each unit to ensure that it meets all ARMEDICA™ quality standards before it leaves the facility. To ensure the longevity of your device, routine maintenance should be followed.

### **AFTER FIRST 40 HOURS OF SERVICE**

- ✓ Physically inspect all fasteners and hardware are properly secured

### **DAILY / Pre-USE**

The operator should visually inspect the unit prior to each use for;

- ✓ Foreign objects that may interfere with operation or create a hazard to patient
- ✓ Signs of damage to unit and power cord
- ✓ All hardware (nuts, bolts, etc.) is present and properly secured
- ✓ All adjustments are secure
- ✓ Unit functions properly

### **CLEANING**

- Use towel dampened with mild soap and water or disinfectant. Wipe down to remove dust, dirt and spills.  
Wipe with dry towel to remove moisture
  - ✓ Upholstered tops
  - ✓ Painted, plated and plastic surfaces
- Painted or plated components should be cleaned with a commercial disinfectant and wiped with a dry cloth to remove any biological contamination when necessary.



**WARNING:** This unit is not rated for wash down, it should not be exposed to standing or quantities of liquid. Do not clean any electronic device with water. Electrical shock and/or damage to electronics may occur.

## **TROUBLESHOOTING**

If this device becomes inoperative, or any problem should occur, remove power from the device and contact Armedica Mfg. Customer Service 1(479) 996-2612.



**ATTENTION:** The AC Mains Cable serves as the  
**EMERGENCY DISCONNECT DEVICE**

Do not position this device in a manner that would make it difficult to reach the AC mains supply cable. In the event of an emergency, unplug the AC Mains Cable from the external power supply.

**WARNING:** Disconnect main power to unit before servicing foot bar controls or cables. Electrical shock and/or damage to electronics may occur.

**WARNING:** Do not alter or modify this device in any way. Altering this device will void all warranties. Serious personal injury and/or damage to equipment may occur.

**WARNING:** Use only replacement parts approved by Armedica Manufacturing. Failure to do so could result in damage to device, increased emissions and serious injury.

## **TECHNICAL SPECIFICATIONS**

### **ENVIRONMENTAL CONDITIONS**

Operating/storage temp. 5°C – 40°C / 41°F – 104°F

Humidity: 5% to 85%

Pressure/altitude: 700hPa to 1060hPa

### **GENERAL SPECIFICATIONS**

Manufactured and assembled by:

Armedica by Pivotal Health Solutions.

Greenwood, Arkansas, USA Tel.: (479) 996-2612

### **Static & Dynamic load capacity**

Max 1,000Lbs/454Kgs operating load.



**DANGER:** This device uses Movotec NT15 hydraulic oil, a food-grade lubricant. NSF H1 registered Number 144005. If leak occurs, discontinue use and call customer service. Hydraulic oil may be fatal if swallowed and enters airways. If swallowed: Immediately call poison control center/doctor. Do Not induce vomiting.



**CAUTION:** Do not exceed Maximum load capacity. Damage to unit and/or serious injury may occur.



**CAUTION:** Do not throw in trash. Expected service life of this device is approximately 10 years. Dispose of this device in accordance with local, state and national environmental regulations. Failure to do so may constitute a criminal act.

### **ELECTRICAL SPECIFICATIONS**

#### **Models equipped with TiMotion Actuation Systems**

Main input power requirements:

100-240VAC ~

50/60Hz, 4,000mA

Duty cycle 10% 2min. on / 18min. off

Manufactured by:

TiMotion Technologies / TiMotion USA

1535 Center Park Drive

Charlotte, NC. 28217, USA. Tel.: (704) 708-6924 Toll-free 1-855-235-1424

Email: [sales.us@timotion.com](mailto:sales.us@timotion.com)

AMTM-640  
AMTM-650  
AMTM-660

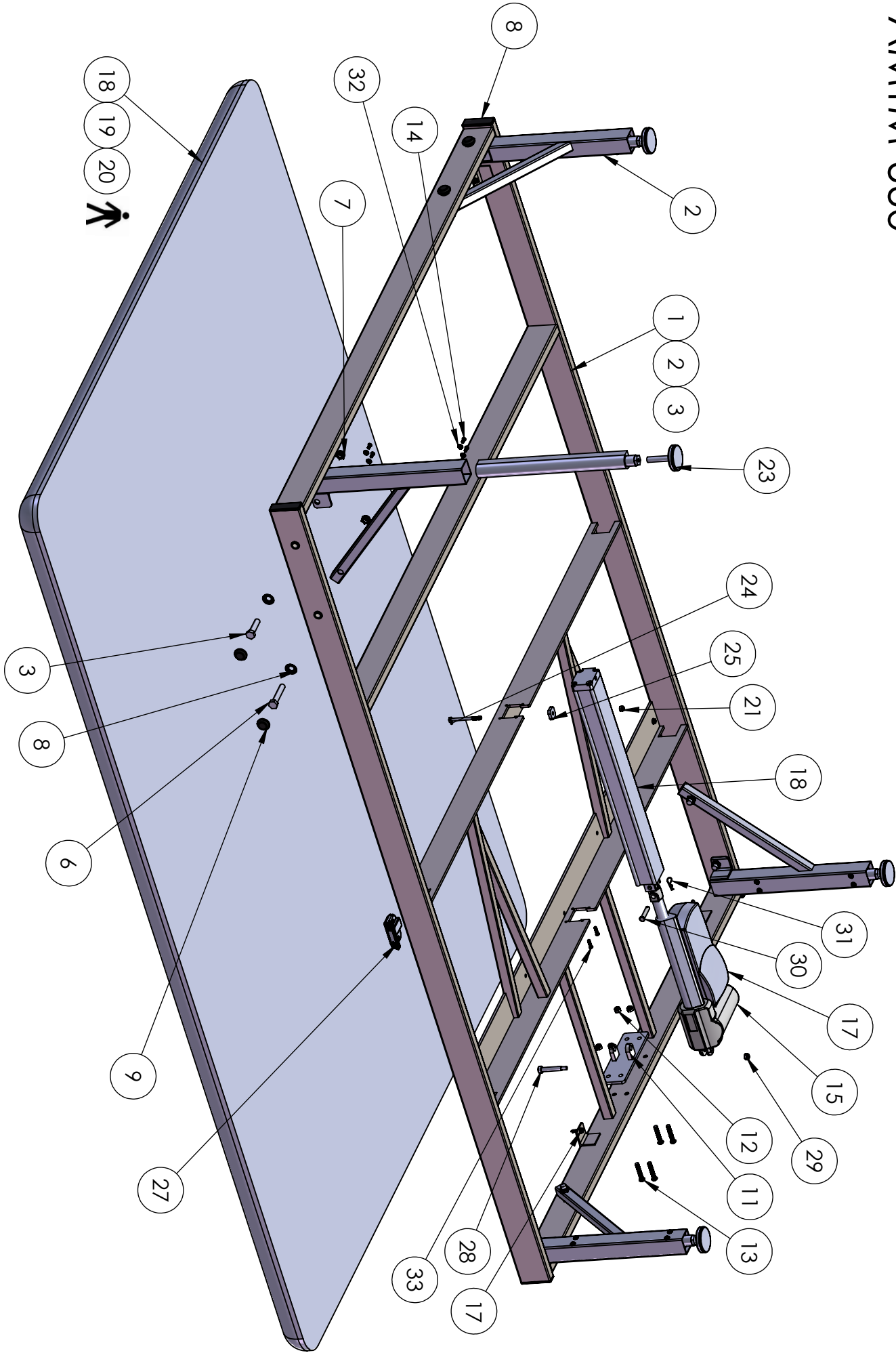

ITEM #	PART #	DESCRIPTION	QTY.
1	18078A	FRAME TOP PWR MAT 6 x 8 PNTD	1
2	18070A	FRAME TOP TIMO MAT 5X7 PNTD	1
3	18074A	FRAME TOP AMTM 640 4x7 MAT PNTD	1
4	18400B	LEG WELDED PAINTED	4
5	02046A	Screw Hx Hd Cap 1/2-13X2	4
6	02047A	Screw Hx Hd Cap 1/2-13X2-3/4	4
7	02095A	NUT NYLOCK JAM 1/2-13	8
8	03011A	WASHER RHW-207 FINISH CAP	8
9	03012A	CAP FINISH BLACK BOLT COVER	8
10	03016A	PLUG 1x3x14GA	4
11	18072A	MAT MTR MNT PLT ASSEM PNTD	1
12	02105A	NUT NYLOCK 5/16-18	4
13	2684	SCREW BTN HD SOC 5/16-18x1-3/4	4
14	02713A	Screw btn head socket cap M5-0.8 x12	16
15	03616A	MTR TiM TA1-5B-200415 SX H/L	1
17	3614	CONTROL TC21	1
18	03405A	SUSPA HYDO LIFT SYSTEM MAT	1
19	14404A 	BD UPH 6x8 STEEL MAT TABLE	1
20	14409A 	BD UPH 4x7 PWR MAT	1
21	14410A 	BD UPH 5x7 STEEL MAT	1
22	02065A	SCREW HX WASHER HD #14x1	10
23	3068	GLIDE SUSPA MAT FOOT	4
24	02069A	SCREW HX HD CAP 1/4-20x3	1
25	12300A	BAR 1/4x1x1 AM100 SIDE RAIL SPCR PLTD	1
26	02100A	NUT NYLOCK 1/4-20	1
27	03619A	TDH8-5035-001	1
28	2026	BOLT SHLDR M10x50	1
29	2092	NUT NYLOCK M8-1.25 HEAVY	1
30	2169	PIN CLEVIS 3/8x1-3/4	1
31	03173A	PIN HITCH CLIP 1/16X1-3/16	1
32	02104A	WASHER 1/4" INTERNAL TOOTH LOCK	16
33	02770A	Screw btn hd cap M5-0.8x20mm	4

## ARMEDICA™ LIMITED WARRANTY

ARMEDICA™ warrants that the AM-Series Mat Platforms are free from defects in material and workmanship. This warranty shall remain in effect for 18 months from the date of original consumer purchase of the product. The Hydraulic units on the Power Mat Platforms and Adjustable Mat Platforms are warranted to be free from defects in materials and workmanship for 18 months from the date of original consumer purchase of the product. The welded steel frames on all Mat Platforms are warranted to be free from defects in materials or workmanship for 5 years from the date of original consumer purchase of the product. If the table fails to function during the warranty period due to a defect in material or workmanship, ARMEDICA™ or the selling Dealer will repair or replace the table without charge within a 30 day period from the date on which the table is returned to ARMEDICA™ or the selling Dealer.

## THIS WARRANTY DOES NOT COVER

1. Replacement parts or labor furnished by anyone other than ARMEDICA™, Selling Dealer or any approved ARMEDICA Service Agent. Parts lists are for reference only when speaking with an ARMEDICA representative. Replacements and repairs are to be done by an approved ARMEDICA Service Agent.
2. Any failure of the table during the warranty period if the failure is not caused by a defect in material or workmanship or if the failure is caused by unreasonable use, including the failure to provide reasonable and necessary maintenance.

ARMEDICA™ IS NOT LIABLE FOR INCIDENTAL OR CONSEQUENTIAL DAMAGE TO PROPERTY OR BUSINESS.

TO OBTAIN SERVICE from ARMEDICA™ or the Selling Dealer under this warranty, please do the following:

1. A written claim should be sent to ARMEDICA™, P.O. Box 880, Greenwood, AR. 72936-0880 or the selling Dealer.
2. The table must be returned to ARMEDICA™ or the selling Dealer.
3. This warranty gives you specific legal rights and you may have other rights which vary from state to state.

ARMEDICA™ does not authorize any person or dealer to create for it any other obligations or liabilities in connection with the sale of the tables. Any representation or agreement not contained in this warranty shall be void. Disposal of unused or unwanted product should be in accordance with applicable regional, national, and local laws. For information contact the local regulatory agency.

<b>ARMEDICA</b>		
<b>By: Pivotal Health Solutions</b>		
INPUT: 110-240V ~, 50/60Hz, 4,000mA, DUTY Cyc: Int. On/Off 1min/9min		
Maximum Load: 1,000Lbs/454Kgs		
Model No. <div style="border: 1px solid black; height: 20px; width: 100%;"></div>	Serial No. <div style="border: 1px solid black; height: 20px; width: 100%;"></div>	Prod. Date <div style="border: 1px solid black; height: 20px; width: 100%;"></div>
ETL CLASSIFIED  Intertek 4009555	ARMEDICA MFG. 212 BELL RD, GREENWOOD, AR 72936 CUSTOMER SERVICE (479) 996-2612 <b>DANGER:</b> Risk of explosion if used in the presence of flammable anesthetics Conforms to ANSI/UL Std. 60601-1 Certified to CSA Std. C22.2 Std. 601.1	06030E 